

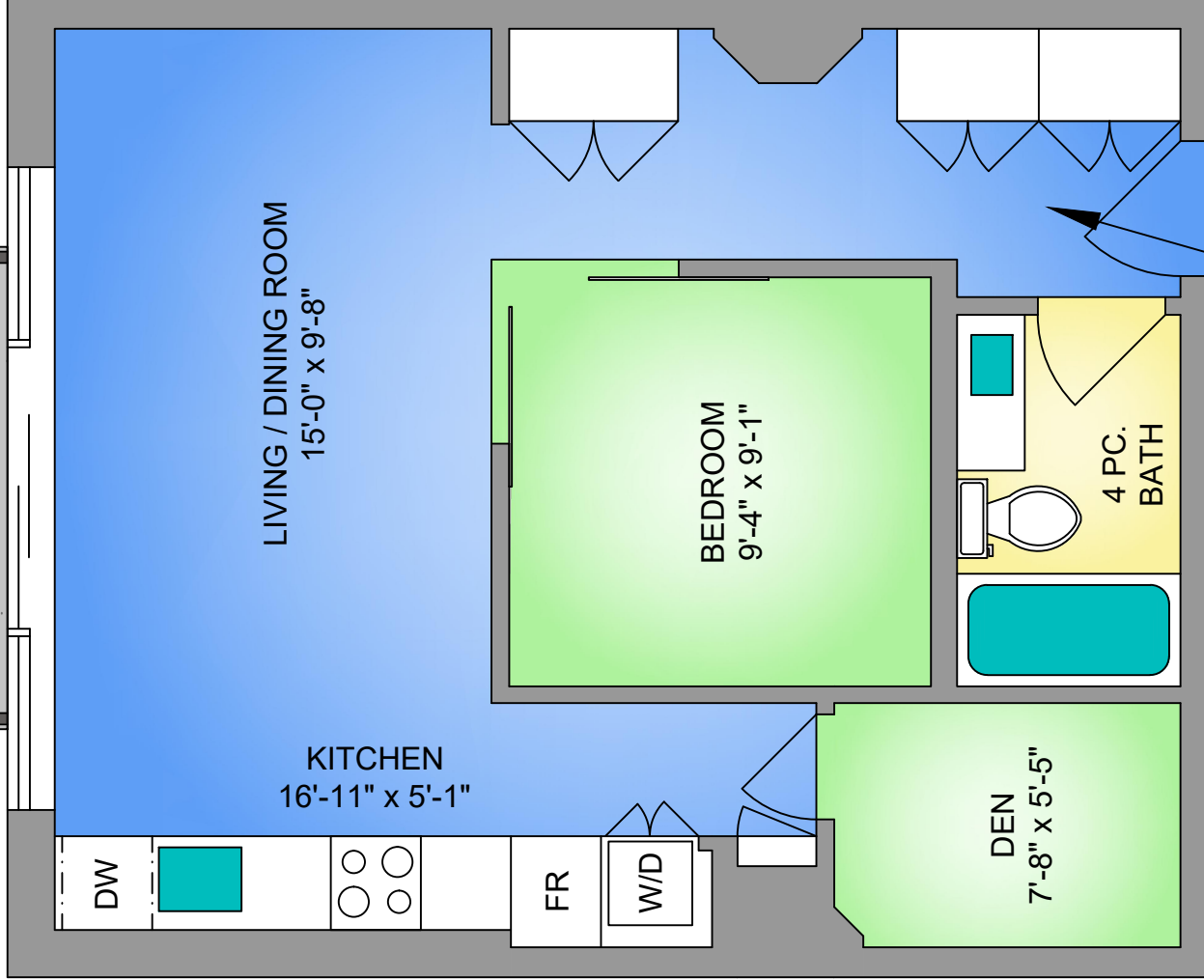

COLDWELL BANKER
OCEANSIDE
REAL ESTATE

BALCONY
 10'-9" x 8'-4"

UNIT 319 - 770 FISGARD STREET
565 SQ. FT.
 14'-3" CEILING HEIGHT



NORTH

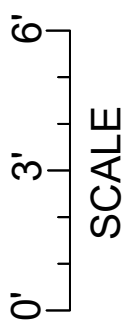
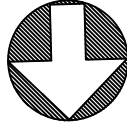

ENTRY
 5'-0" x 3'-11"

UNIT 319 - 770 FISGARD STREET		
JANUARY 6, 2020		
PREPARED FOR THE EXCLUSIVE USE OF		
PLANS MAY NOT BE 100% ACCURATE. IF CRITICAL BUYER TO VERIFY.		
FLOOR	AREA (SQ. FT.)	BALCONY
THIRD	565	90



250-884-9753
 matt@propermeasure.com
 www.propermeasure.com